

EL10 L2.05M 2KSO 8.10 (410 020)

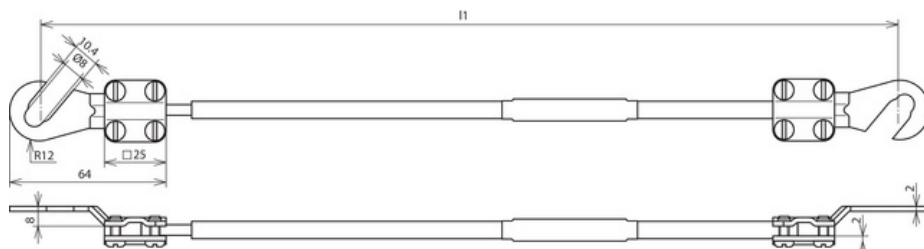

Figure without obligation

Type	EL10 L2.05M 2KSO 8.10
Part No.	410 020
Cable cross section	10 mm ²
Cable length (l1)	2.05 m
Cable lug open	2x M8 / M10
Conductor	Cu highly flexible
Single wire diameter	0,1 mm
Operating voltage resistance (AC / DC)	600 V
Temperature range	-40 °C ... +150 °C
Colour	black •
Cable lug material	Cu/gal Sn
Screw	⬆ ⬇ M4 x 10 mm
Material of screw	St/gal Zn
Weight	300 g
Customs tariff number (Comb. Nomenclature EU)	85369010
Stock No.	6150-12-156-9073
GTIN	4013364028678
PU	1 pc(s)

We reserve the right to introduce changes in performance, configuration and technology, dimensions, weights and materials in the course of technical progress. The figures are shown without obligation.

Packing in accordance with specifications of the VG standards has to be explicitly indicated when ordering.