

EL16 L4.05M 2KSO 8.10 (416 040)

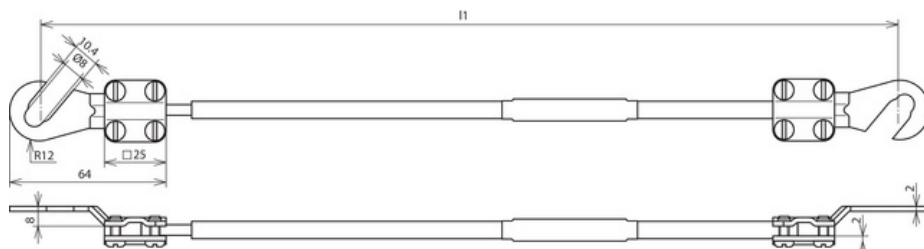

Figure without obligation

Type	EL16 L4.05M 2KSO 8.10
Part No.	416 040
Cable cross section	16 mm ²
Cable length (l1)	4.05 m
Cable lug open	2x M8 / M10
Conductor	Cu highly flexible
Single wire diameter	0.1 mm
Operating voltage resistance (AC / DC)	600 V
Temperature range	-40 °C ... +150 °C
Colour	black •
Cable lug material	Cu/gal Sn
Screw	⬆ ⬇ M4 x 10 mm
Material of screw	St/gal Zn
Weight	830 g
Customs tariff number (Comb. Nomenclature EU)	85369010
Stock No.	6150-12-156-8388
GTIN	4013364028845
PU	1 pc(s)

We reserve the right to introduce changes in performance, configuration and technology, dimensions, weights and materials in the course of technical progress. The figures are shown without obligation.

Packing in accordance with specifications of the VG standards has to be explicitly indicated when ordering.