

## EL16 L1.55M 2KSO 8.10 GG (417 015)

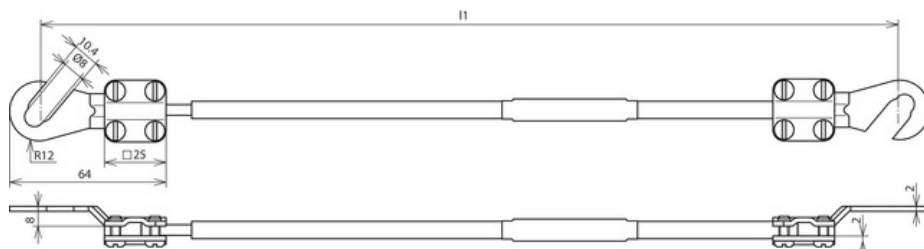
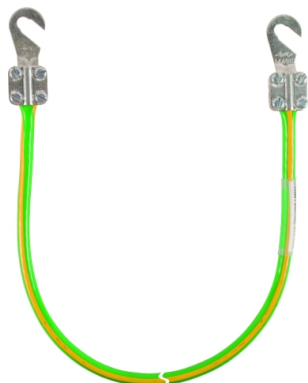

Figure without obligation

Type	EL16 L1.55M 2KSO 8.10 GG
Part No.	417 015
Cable cross section	16 mm <sup>2</sup>
Cable length (l1)	1.55 m
Cable lug open	2x M8 / M10
Conductor	Cu highly flexible
Single wire diameter	0.07 mm
Temperature range	-40 °C ... +90 °C
Colour	green ● / yellow ●
Cable lug material	Cu/gal Sn
Screw	⬆ ⬇ M4 x 10 mm
Material of screw	St/gal Zn
Weight	353 g
Customs tariff number (Comb. Nomenclature EU)	85369010
Stock No.	6150-12-313-5061
GTIN	4013364031968
PU	1 pc(s)

We reserve the right to introduce changes in performance, configuration and technology, dimensions, weights and materials in the course of technical progress. The figures are shown without obligation.

Packing in accordance with specifications of the VG standards has to be explicitly indicated when ordering.