

## EL10 L1.05M 2KSG 10 (410 910)

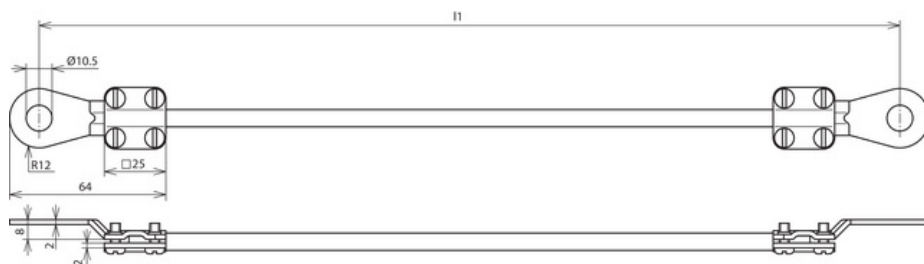

Figure without obligation

| Type  | EL10 L1.05M 2KSG 10 |
|---|---------------------|
| Part No.                                      | 410 910             |
| Cable cross section                           | 10 mm <sup>2</sup>  |
| Cable length (l1)                             | 1.05 m              |
| Cable lug closed                              | 2x M10              |
| Bore Ø  | 10.5 mm             |
| Conductor                                     | Cu highlyflexible   |
| Operating voltage resistance (AC / DC)        | 600 V               |
| Temperature range                             | -40 °C ... +150 °C  |
| Colour  | black •             |
| Cable lug material                            | Cu/gal Sn           |
| Screw   | ⬆ M4 x 10 mm        |
| Material of screw                             | St/gal Zn           |
| Weight  | 200 g               |
| Customs tariff number (Comb. Nomenclature EU) | 85369010            |
| Stock No.                                     | 6150-12-198-1482    |
| GTIN  | 4013364029064       |
| PU  | 1 pc(s)             |

We reserve the right to introduce changes in performance, configuration and technology, dimensions, weights and materials in the course of technical progress. The figures are shown without obligation.

Packing in accordance with specifications of the VG standards has to be explicitly indicated when ordering.