

EL10 L2.05M 2KSG 10 (410 920)

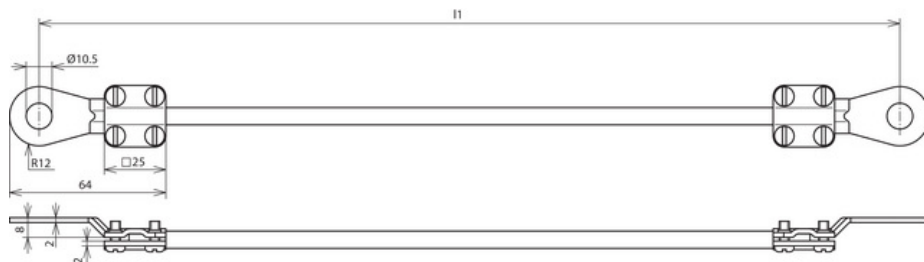

Figure without obligation

Type	EL10 L2.05M 2KSG 10
Part No.	410 920
Cable cross section	10 mm ²
Cable length (l1)	2.05 m
Cable lug closed	2x M10
Bore Ø	10.5 mm
Conductor	Cu highly flexible
Operating voltage resistance (AC / DC)	600 V
Temperature range	-40 °C ... +150 °C
Colour	black •
Cable lug material	Cu/gal Sn
Screw	⬆ M4 x 10 mm
Material of screw	St/gal Zn
Weight	320 g
Customs tariff number (Comb. Nomenclature EU)	85369010
Stock No.	6150-12-168-2695
GTIN	4013364029088
PU	1 pc(s)

We reserve the right to introduce changes in performance, configuration and technology, dimensions, weights and materials in the course of technical progress. The figures are shown without obligation.

Packing in accordance with specifications of the VG standards has to be explicitly indicated when ordering.