

## EL16 L0.55M 2KSG 10 (416 905)

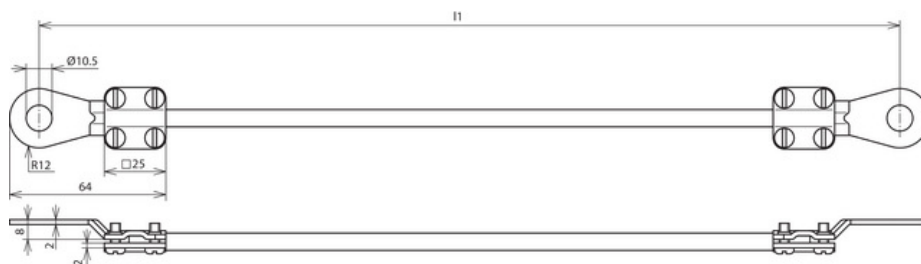

Figure without obligation

Type	EL16 L0.55M 2KSG 10
Part No.	416 905
Cable cross section	16 mm <sup>2</sup>
Cable length (l1)	0.55 m
Cable lug closed	2x M10
Bore Ø	10.5 mm
Conductor	Cu highly flexible
Operating voltage resistance (AC / DC)	600 V
Temperature range	-40 °C ... +150 °C
Colour	black •
Cable lug material	Cu/gal Sn
Screw	⬆ M4 x 10 mm
Material of screw	St/gal Zn
Weight	180 g
Customs tariff number (Comb. Nomenclature EU)	85369010
Stock No.	6150-12-198-6813
GTIN	4013364028951
PU	1 pc(s)

We reserve the right to introduce changes in performance, configuration and technology, dimensions, weights and materials in the course of technical progress. The figures are shown without obligation.

Packing in accordance with specifications of the VG standards has to be explicitly indicated when ordering.