

AS SCHR M12 M12 40 (705 504)

- For earth connecting elements to be screwed on with wing nut or wing bolt



Figure without obligation

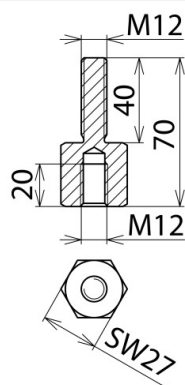

Figure without obligation

Type	AS SCHR M12 M12 40
Part No.	705 504
Dimensions	M12 / M12 x 40 mm
Width A/F	27 mm
Max. cable cross-section Cu	150 mm ²
Max. short-circuit current I _k 0.5 s	42.0 kA
Max. short-circuit current I _k 1 s	29.6 kA
Standard	EN/IEC 61230 (DIN VDE 0683-100) and DIN 48088-5
Material	Copper alloy/gal Sn
Weight	183 g
Customs tariff number (Comb. Nomenclature EU)	85389099
GTIN	4013364008021
PU	5 pc(s)

We reserve the right to introduce changes in performance, configuration and technology, dimensions, weights and materials in the course of technical progress. The figures are shown without obligation.